

REGISTER NOW TO  
ACTIVATE YOUR

**5** YEAR  
WARRANTY\*

[www.purpleline.co.uk](http://www.purpleline.co.uk)  
01473 601200

Hitch Lock

PRODUCT CODE: **FHL555**

Thatcham<sup>®</sup>

Quality Assured

Category 3

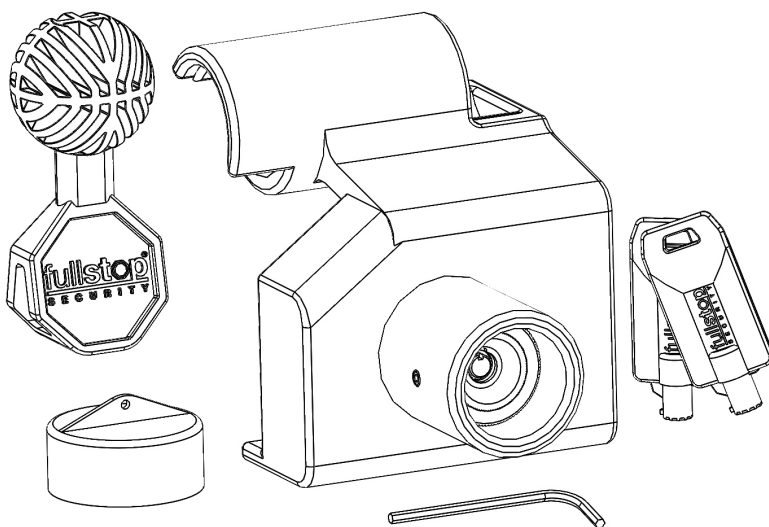

# PARTS IDENTIFICATION

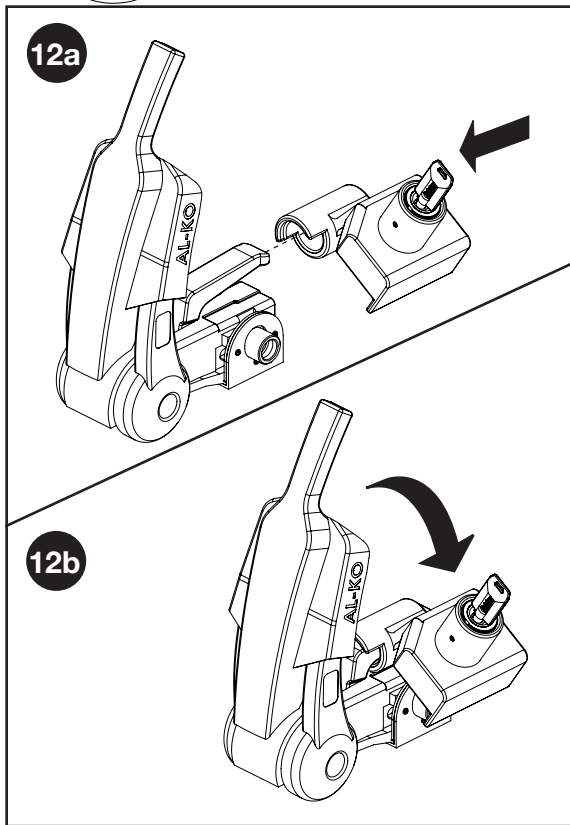
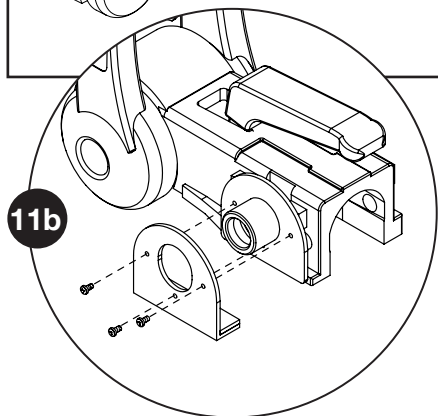
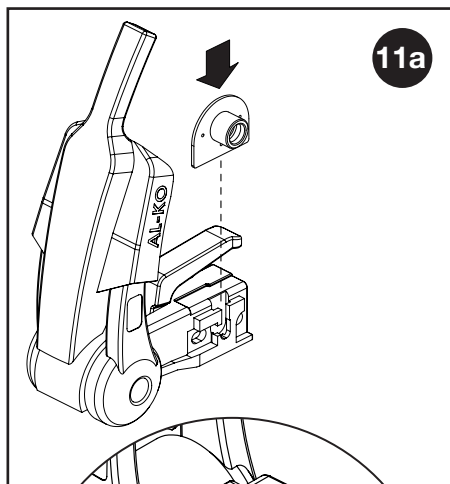
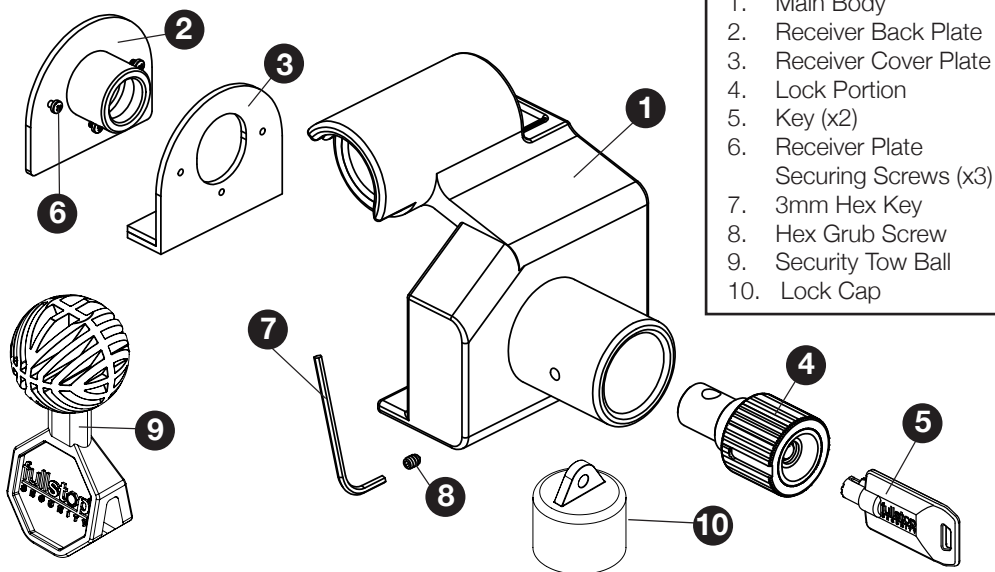

## ASSEMBLY & INSTALLATION

The FullStop® Saracen Gullwing Hitch Lock can be used when your caravan is hitched or unhitched, but should never be fitted during transit. It is against the law in the UK to tow whilst using a hitch lock. It is designed to fit AL-KO AKS2004 & AKS3004 stabiliser couplings.

1. Slide the Receiver Back Plate (2) onto your AL-KO stabiliser coupling. There is a recess in the casting (see diagram 11a).
2. Fit the Receiver Cover Plate (3) onto the Receiver Back Plate (2). Line up the holes and secure with the three Receiver Plate Securing Screws (6) using a crosshead screwdriver (see Diagram 11b).
3. If not already installed, screw in the Hex Grub Screw (8) into the Main Body (1) but only by a few threads at this stage
4. Locate the Lock Portion (4) into the Main Body (1). Line up the groove in the side of the knurled section of the lock with the Hex Grub Screw (8). Insert the lock into the main body and tighten the Grub Screw (8). The grub screw holds the lock in the Main Body.

## FITTING WHEN HITCHED

5. Insert one of the Keys (5) into the lock, push and turn 90° degrees clockwise to release the ball-bearing mechanism.
6. Locate the Main Body (1) over the handle of the coupling at approximately a 45° degree angle (see diagram 12a).
7. With the Lock Portion (4) fully retracted from the Main Body tube, pivot the Main Body (1) over the Receiver assembly (2,3). Use the Key to hold the Main Body assembly (see diagram 12b).
8. Push the lock into the tube on the Main Body. The lock will then locate into the receiver tube.
9. Lock the Hitch Lock by turning the key 90° degrees counter-clockwise. If the key will not turn it means that the lock is not properly located into the receiver and you will need to re-adjust the positioning and the Main Body (1) and the Receiver.

## FITTING WHEN UN-HITCHED

10. The only difference when fitting the Hitch Lock when the caravan is unhitched is that the Security Tow Ball (9) must be inserted into the coupling to inhibit the coupling from use.

## MAINTENANCE

Fit the protective Lock Cap (10) to help prevent ingress of dirt or water.

Grease the locking barrel before first use, with a light oil such as 3-IN-ONE or equivalent.

Thereafter spray any moving parts of the lock body with a light oil such as 3-IN-ONE or equivalent every eight weeks.

## NOTE

It is highly recommended that a secondary security device (such as a wheel clamp) should be used to inhibit theft by some unconventional form of towing. Visit [www.purpleline.co.uk](http://www.purpleline.co.uk) for details of other products in the Fullstop® Security range.

# fullstop<sup>®</sup>

## S E C U R I T Y

### PRODUCT SPECIFICATION

FHL555				
Weight (kg)	Height (mm)	Width (mm)	Depth (mm)	Keys Supplied
2.3kg	140mm	115mm	150mm	2

Please store your keys in a safe place and remember to register your product. Your key number is located on both of the keys supplied and will be required in order to purchase replacement keys.

**Registration is quick and simple, go to [www.purpleline.co.uk/product-registration](http://www.purpleline.co.uk/product-registration)**  
**Please register within 14 days of purchase. Please retain your original purchase receipt.**

#### Disclaimer

If used properly, your FullStop<sup>®</sup> product will be an effective deterrent. However, nothing can stop the efforts of the most determined thief, and to this end no liability is accepted for any loss and/or damage caused by any illegal activity including theft or vandalism. Liability also not accepted for any loss and/or damage arising from misuse, unauthorised repair or alteration and failure to follow the user guide directions. No form of consequential loss what so ever will be accepted.



© Copyright 2017. Purple Line Limited, Peninsula Business Centre, Wherstead, Suffolk, IP9 2BB, UK

**[www.purpleline.co.uk](http://www.purpleline.co.uk)**  
**01473 601200**

Photographs for illustration purposes only. Actual product may differ slightly.  
Purple Line Limited reserve the right to alter product specification without prior notice.